

AC INFINITY

CONTROLLER 63

WIRELESS VARIABLE CONTROLLER

USER MANUAL

WELCOME

Thank you for choosing AC Infinity. We are committed to product quality and friendly customer service. If you have any questions or suggestions, please don't hesitate to [contact](#) us. Visit www.acinfinity.com and click contact for our contact information.

EMAIL

support@acinfinity.com

WEB

www.acinfinity.com

LOCATION

Los Angeles, CA

MANUAL CODE WSC2201X1

PRODUCT
CONTROLLER 63

MODEL
CTR63A

UPC-A
819137021730

MANUAL INDEX

Manual Index	Page 5
Product Warning	Page 6
Product Contents	Page 7
Key Features	Page 8
Installation	Page 9
Controller Mounting	Page 11
Programming	Page 13
Other AC Infinity Products	Page 14
Warranty	Page 15

PRODUCT WARNING



TO REDUCE THE RISK OF FIRE, ELECTRIC SHOCK, OR INJURY TO PERSONS, OBSERVE THE FOLLOWING:

1. Ensure your power source conforms to the electrical requirements of this product.
2. Check your local code restrictions for additional safety measures that may be needed for a proper code compliant installation.
3. Read all instructions before installing and using this product.
4. If you are unfamiliar or have doubts about performing this product's installation, seek the services of a qualified, trained, and licensed professional. Inappropriate installation will void this product's warranty.
5. This product must not be used in potentially hazardous locations such as flammable, explosive, chemical-laden or wet atmospheres.
6. Ducted products must always be vented to outdoor areas.
7. Do not cover power cords with rugs or other fabric materials.
8. This product pairs with those that has rotating parts. Safety precautions should be exercised during the installation, operation, and maintenance of this product.
9. Do not insert or allow fingers or foreign objects to enter any ventilation or exhaust openings as it may cause electric shock, fire, or damage to this product. Do not block or tamper with this product in any manner while it is in operation.
10. Do not depend on the on/off programming as the sole means of shutting power from this product. Unplug the power cord before installing, servicing, or moving this product.
11. Do not operate this product while its cord is damaged, or if it malfunctions, has been dropped, or is damaged in any manner.

PRODUCT CONTENTS



WIRELESS VARIABLE
CONTROLLER
(x1)



WIRELESS
RECEIVER
(x1)



MOLEX
ADAPTER
(x1)



AAA
BATTERIES
(x2)



CONTROLLER
PLATE BOLTS
(x2)



WOOD SCREWS
(WALL HANG)
(x2)

KEY FEATURES

WIRELESS CONTROL

Designed to enable AC Infinity UIS™ devices with wireless level control for HVAC or growing applications.



CROSS COMPATIBILITY

Included dongle enables the controller kit to work with AC Infinity fans that have 4-pin Molex or UIS connectors.

10-LEVEL PROGRAMMING

Remotely adjusts 10 settings using PWM controls to produce optimal levels such as fan speed and brightness.

BACKUP MEMORY

Onboard memory chip retains set fan speed level to resume previous programming when fan is reactivated.

LONG DISTANCE SIGNAL

Controller and receiver utilize 433 MHz signaling to enable fan speed adjustment from up to 65 feet away, when unimpeded.

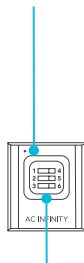

MULTI-DEVICE OPERATION

Control many devices simultaneously when matching multiple receivers' pin numbers to the same controller.

INSTALLATION

STEP 1

Plug your device's UIS connector into the wireless receiver.



FOR DEVICES WITH MOLEX CONNECTORS:

If your device uses a 4-pin Molex connector instead of UIS, use the included Molex adapter. Plug the device's 4-pin Molex connector into the adapter, then plug the wireless receiver into the UIS end of the adapter.

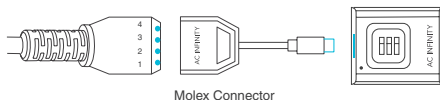

STEP 2

Insert the two AAA batteries into the wireless receiver controller.

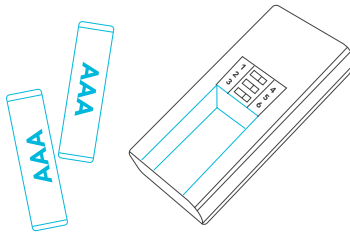

INSTALLATION

STEP 3

Adjust the sliders on the controller and receiver so that their numbers match. Close the controller's battery door when you are finished. The receiver's indicator light will flash when connected.

Any number of devices may be controlled using the same controller, as long as the fans' sliders match the controller's.

Any number of controllers may control the same device, as long as the controllers' sliders match the fan's.

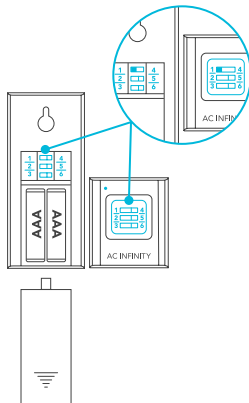

CONTROLLER MOUNTING

STEP 1 — WALL MOUNTING

Locate a spot free of obstruction and secure the anchor into your wall. Twist the wood screw into the anchors.

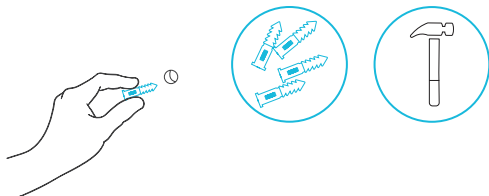

STEP 2 — WALL MOUNTING

Use the mounting hole located on the back of the controller and receiver for wall mount.

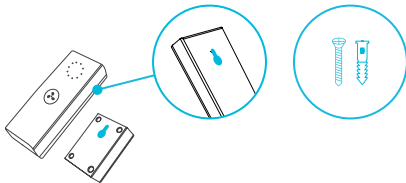

CONTROLLER MOUNTING

MAGNET MOUNTING

Use the magnet located next to mounting hole to mount the controller and receiver.

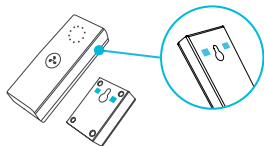
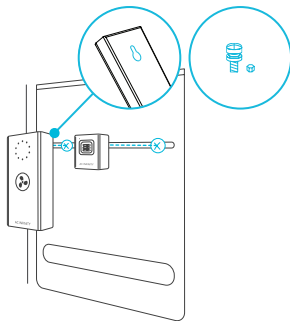

PLATE MOUNTING*

Screw the controller plate bolts into the slit at the upper half of the plate.

Hang the controller and receiver by the bolts using the holes on the backsides.

*Controller plate not included



PROGRAMMING

LIGHT INDICATOR

Features ten LED lights to signify the current level. The LEDs will briefly light up before shutting off. Pressing the button will light up the LEDs.

ON

Press the button will turn your device on at level 1. Continue pressing it to cycle through the ten device levels.

OFF

Hold the button to turn your device off. Press it again to return the device level back to the last setting.

Pressing the button after speed 10 will also turn your device off.

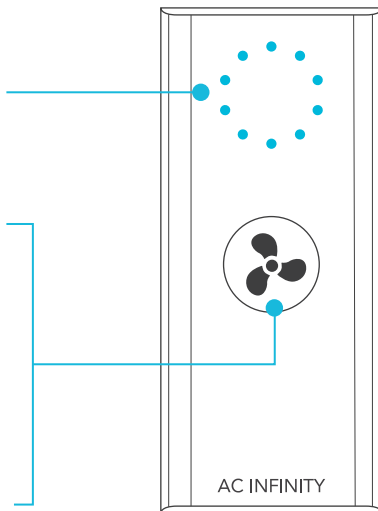

AC INFINITY PRODUCTS

Advance Grow Tents

The CLOUDLAB series is a line of grow tents designed to create ideal growing conditions and facilitate indoor plant cultivation year-round. Features 2000D thick oxford canvas lined with inner diamond patterned mylar that maximizes grow light luminosity, and a reinforced frame with 150 lb. weight capacity. Includes a mounting plate to install your AC Infinity controller onto.

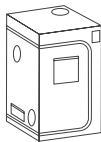

Fabric Pots

A set of gardening grow bags designed to create wider root networks and improve plant growth by air pruning roots while draining excess water. Features industry leading 500G thick nonwoven fabric sewn with metal rings to enable air-suspended hanging or twist tie pass-through for low stress plant training.

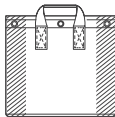

Net Cups

A set of long lasting, reusable net cups designed to promote stronger root structures and even drainage to achieve greater water and nutrient absorption. Features wide lips and durable netting that can withstand use with many soil-based and hydroponic media such as expanded clay pebbles, lava rocks, pumice, and rock wool.

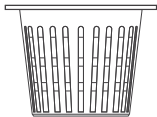

Discover the latest innovations in cooling and ventilation at acinfinity.com

WARRANTY

This warranty program is our commitment to you, the product sold by AC Infinity will be free from defects in manufacturing for a period of two years from the date of purchase. If a product is found to have a defect in material or workmanship, we will take the appropriate actions defined in this warranty to resolve any issues.

The warranty program applies to any order, purchase, receipt, or use of any products sold by AC Infinity or our authorized dealerships. The program covers products that have become defective, malfunctioned, or expressly if the product becomes unusable. The warranty program goes into effect on the date of purchase. The program will expire two years from the date of purchase. If your product becomes defective during that period, AC Infinity will replace your product with a new one or issue you a full refund.

The warranty program does not cover abuse or misuse. This includes physical damage, submersion of the product in water, incorrect installation such as wrong voltage input, and misuse for any reason other than intended purposes. AC Infinity is not responsible for consequential loss or incidental damages of any nature caused by the product. We will not warrant damage from normal wear such as scratches and dings.

To initiate a product warranty claim, please contact our customer service team at support@acinfinity.com



If you have any issues with this product, contact us and we'll happily resolve your problem or issue a full refund.

COPYRIGHT © 2022 AC INFINITY INC. ALL RIGHTS RESERVED

No part of the materials including graphics or logos available in this booklet may be copied, photocopied, reproduced, translated or reduced to any electronic medium or machine readable form, in whole or in part, without specific permission from AC Infinity Inc.

www.acinfinity.com